



Green Office

- ✔ The world's first multifunctional device which uses erasable toner
- ✔ Reuse your paper and save up 80% of valuable resources
- ✔ State-of-the-art Toshiba technology combined with unique functionality
- ✔ Extremely environment-friendly as it helps to reduce carbon emissions



 **INSIGHT**
Insight Systems Ltd
w: www.insightsystems.co.uk
e: sales@insightsystems.co.uk
t: 01732 880600

e-STUDIO306LP
e-STUDIORD30



SAP® Printer Vendor Solution



Changing the way you print

Toshiba has developed a revolutionary new system which will change the way you print. Instead of throwing away prints which are not needed anymore, you can then erase and reuse the paper.

The Toshiba Paper Reusing Device e-STUDIO RD30 is capable of de-colourising the text and images on documents printed on the e-STUDIO306LP allowing you to reuse the paper.¹⁾ This significantly reduces the paper consumption. As a result, you save valuable resources and contribute to a greener tomorrow, today.

¹⁾ As latent toner remains on the paper after erasing, it is not recommended to print confidential documents on this system.

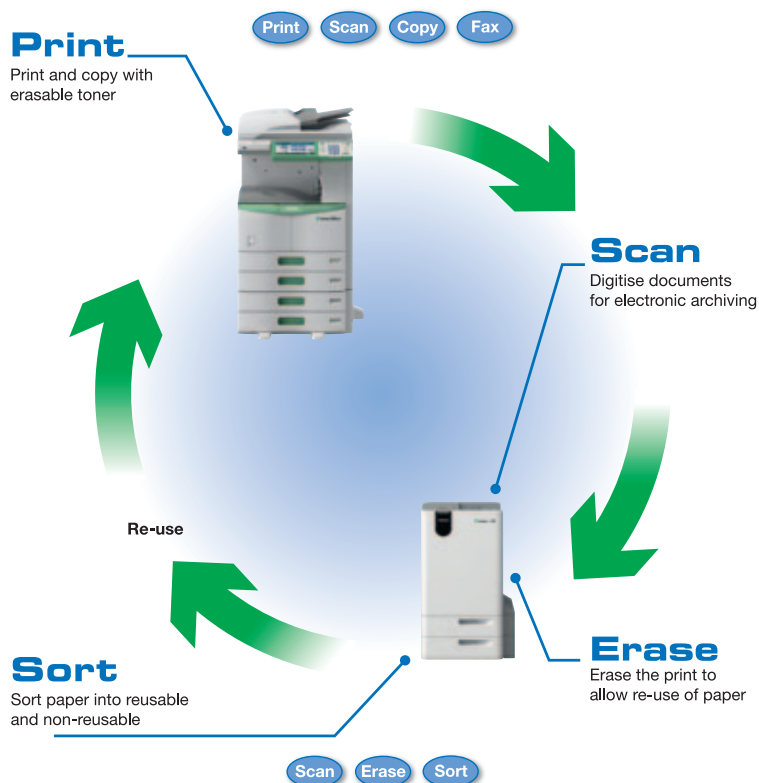

Paperless vs. less paper

The arrival of paperless offices has been predicted for over 30 years, yet still we print billions of pages each year. According to an IDC study¹⁾ two million A4 pages are printed every minute in the EMEA region (Europe, Middle East and Africa) alone. That amounts to almost three billion pages per day!

Many of these prints do not need to be filed and are simply thrown away. With the e-STUDIO306LP/RD30 Toshiba now allows you to reuse the paper. On an average each sheet can be used up to five times. This has a significant impact on the environment.

So even if the time for paperless offices has not yet come, you can now use less paper without having to print less.

¹⁾ IDC. Worldwide Page Volume and Vendor Share Program, October 2012.





The office revolution: $5 \times 1 = 1$

Toshiba now allows you to reuse your paper, which leads to a better value-for-money ratio.

To optimise the use of resources is an effective way to increase profitability. By using one sheet of paper five times with the e-STUDIO306LP/RD30, i.e. re-using it four times, you reduce your paper consumption by 80% without needing to print less.

Assuming that you print 4,000 pages per month this means that after five years you will have saved 192,000 sheets of paper. In other words: The same amount of paper which you would usually use in one year, will now last five years!

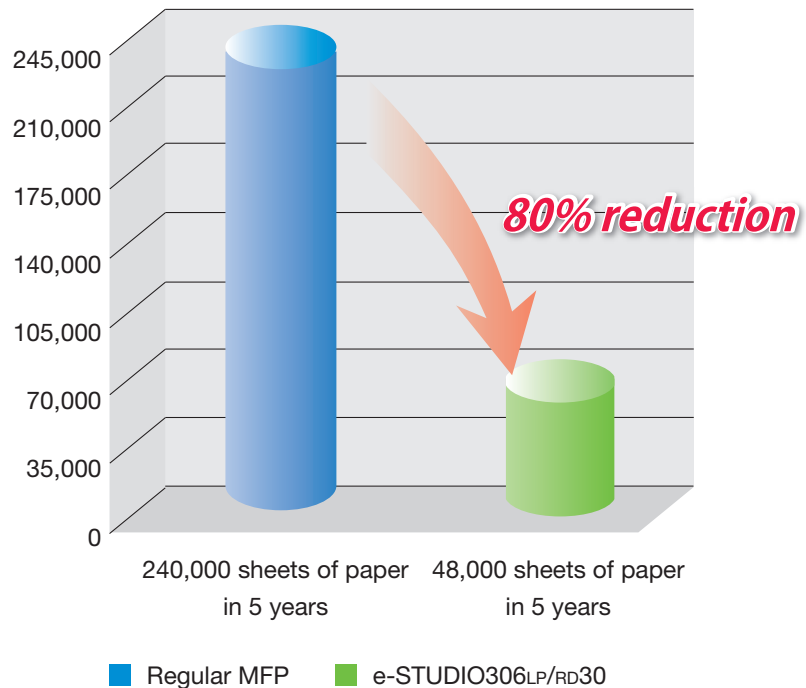

Reuse before recycling

Reduce - Reuse - Recycle. These 3R's are the base of environmental awareness. The e-STUDIO306LP/RD30 now fills the gap and makes reuse of paper possible.

Most of our natural resources are limited and using them as efficiently as possible is mandatory if we want to be responsible citizens.

Trees are renewable resources, but it takes a lot more to make paper. The process involves among others the use of water - a natural resource which is vital for all known forms of life, but

is becoming scarcer in certain parts of the world.

Over the past few years the process of making paper has become more and more environmentally friendly. Decades of innovations have resulted in resources being used to their fullest extent. Additionally, recycling paper has helped save resources.

Toshiba has now added a new level to environmentally conscious use of paper: Reusing it before recycling it. By using paper five times with the e-STUDIO306LP/RD30 before recycling it, it is possible to save 80% of natural resources otherwise needed to print the same volume.



For a greener tomorrow, today

Efforts to reduce carbon emissions are being made on a global level. With the possibility to reuse paper when printing, the e-STUDIO306LP/RD30 helps achieve this goal.

Greenhouse gases have a huge impact on the global climate and efforts to reduce the CO₂e emission are being made all over the world. The European Union, for example, aims at reducing the greenhouse gas emissions by 80% by 2050.¹⁾

Over the entire life cycle of an MFP it is the paper - not the manufacturing, transport or usage - which accounts for largest part of the CO₂e emission. This is due to the fact that when producing one tonne of paper, approximately one tonne of CO₂e is emitted.²⁾

As the e-STUDIO RD30 is capable of erasing text and images from documents printed on the e-STUDIO306LP, it allows you to reuse the paper. When using each sheet five times, you reduce your paper consumption by 80%. This of course also significantly reduces the CO₂e emission and helps protect the environment.

If you would like to calculate the CO₂e savings based on your individual print volume, please visit us at 5x1.toshiba.eu/BR.



Technically speaking...

CO₂ vs. CO₂e

Carbon dioxide (CO₂) is one of the most prevalent greenhouse gases and has become a proxy when measuring greenhouse gas emissions. However, it is only one of many greenhouse gases. Others include water vapour, methane, nitrous oxide and ozone.

To take into account the emission of these other greenhouse gases an equivalent measure has been devised by scientists: the CO₂e (carbon dioxide equivalent). It allows other greenhouse gases to be expressed in terms of CO₂.

The calculation is based on the relative global warming potential (GWP) of the different greenhouse gases. With CO₂ having a GWP of 1, methane (CH₄) e.g. has a GWP of approximately 25. Therefore, the emission of one tonne of CH₄ is equivalent to emitting 25 tonnes of CO₂.

So by using the CO₂e a far more accurate greenhouse gas emission can be measured, giving you a more precise picture of the effects of these emissions.

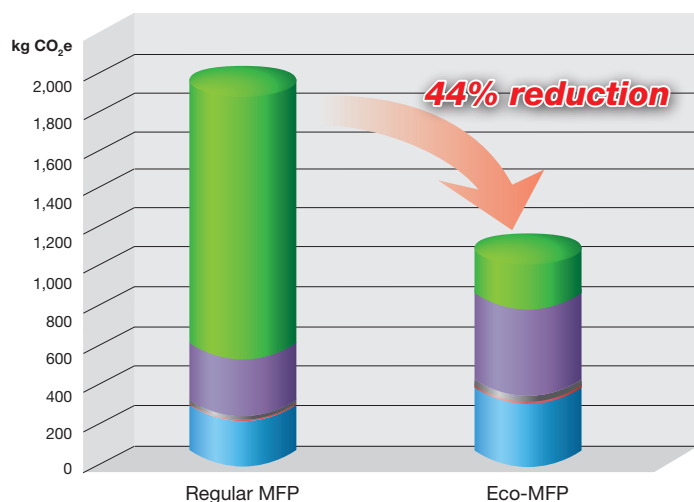

- Raw materials
- Manufacturing
- Transportation
- Usage
- Paper

Comparison of CO₂e emission assuming an average monthly document volume of 5,000 A4 sheets over five years and 5-time usage of paper. Based on the average kg CO₂e per kWh in the European Union. Value will differ depending on country, average monthly document volume, life cycle and paper reuse.



Fully integrated into your fleet

The e-STUDIO306_{LP} is more than just a green MFP. Its advanced technology is based on the Toshiba e-BRIDGE controller which ensures flexible connectivity with diverse applications and workflows.

Functionality

The e-STUDIO306_{LP} offers you full functionality. Monochrome printing and copying with special blue toner as well as the colour scan function come as standard. You can also extend the systems functionality by adding the optional fax.

Productivity

With a paper capacity of 2,300 sheets the e-STUDIO306_{LP} is ready to handle even larger print jobs. You can make full use of a speed of 30 pages per minute without the need to refill paper.

The system can also scan in colour with a resolution of up to 600 x 600 dpi, with a scan speed of up to 57 images per minute.

Usability

All Toshiba products are designed with the customer's needs in mind. The intuitive to use 9" (22.8 cm) LCD touch panel lets you access all functions the e-STUDIO306_{LP} has to offer with just a few clicks, ensuring a smooth workflow.

Connectivity

Thanks to the Toshiba e-BRIDGE controller the e-STUDIO306_{LP} becomes part of your modern workflow. A large choice of optional plug-ins, connectors or a fleet management tool allow you to easily customise the system according to your needs and existing workflows.

e-BRIDGE Technology

The Toshiba e-BRIDGE technology is the high-tech core of almost all of our e-STUDIO systems. It is the functional foundation for fast document processing and highly productive applications.

This technology enables you to take advantage of the user-friendly features of Toshiba's Universal Printer Driver and enjoy the intuitive user interface on all e-BRIDGE-based devices. It also allows simple yet effective administration and service of your entire Toshiba fleet.



¹⁾ European Union. *A Roadmap for moving to a competitive low carbon economy in 2050*. 8th March 2011.

²⁾ Defra. *Guidelines to Defra /DECC's GHG Conversion Factors for Company Reporting*. 2011, p. 40.



Save and erase

The e-STUDIO RD30 fully integrates into your digital workflow. It is capable of electronically archiving the content of your documents before erasing it.

The e-STUDIO RD30 can do more than just de-colourise paper. It is capable of converting your documents into electronic files and saving them for you.

Equipped with a single pass duplex scanner the system ensures fast conversion into JPG, TIFF or PDF format. These files are then stored on your server and become part of your digital archive, giving you access to the content at any time.

Once the document has been digitised, the content of the sheet is erased. For this the special toner on the paper is de-colourised by applying heat.

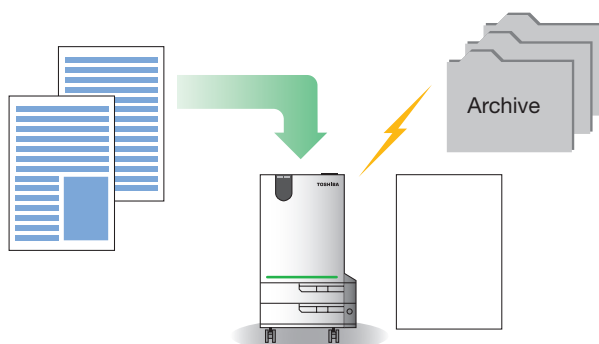

As a consequence the toner turns from blue to transparent, thus virtually erasing everything that was printed.

In a last step, the just erased sheet is scanned yet again and sorted into reusable and non-reusable paper and placed in the respective output cassette.

This entire process - archiving, erasing, sorting - is done fully automatically within just a few seconds. So with the new e-STUDIO306LP/RD30, being environmentally conscious will not stop you from using your time as productively as you are used to.

Permanent and non-permanent documents

Some documents have to be printed, kept and filed and in many cases this is due to legal obligations. These are permanent documents, printed with the intention to be kept long-term. On the other hand, documents are often printed for short-term use. The e-STUDIO306LP/RD30 is the perfect solution for non-permanent documents. Simply re-use the paper for your next no-permanent print job, over and over again.





Ecology - Economy - Efficiency

- Reduce CO₂e emission by reusing paper.
- Save money by using less paper.
- Use your existing document workflow to be more ecological and economical.

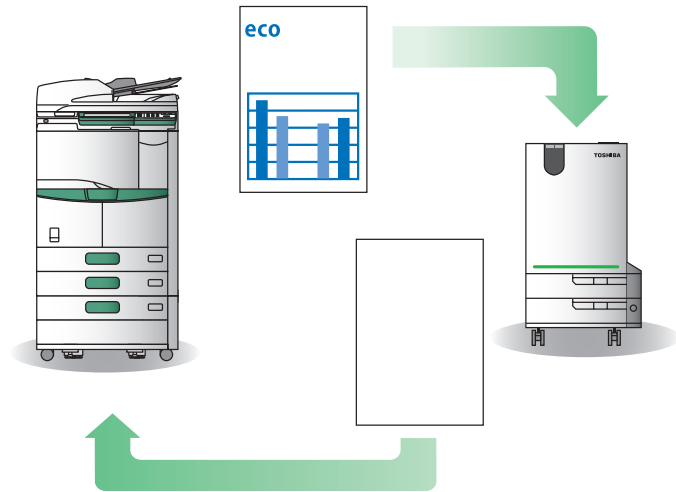

Technical Specifications

e-STUDIO RD30		
General	<p>Feeding Speed Up to 30 sheets per minute</p> <p>Warm-up Time Approx. 40 seconds</p> <p>Paper Size & Weight A5R-A4R, 64-80 gsm</p> <p>Paper Capacity Document feeder: up to 100 sheets</p> <p>Output Trays Re-usable paper cassette: up to 400 sheets</p> <p>Control Panel Rejected paper cassette: up to 100 sheets</p> <p>Memory Graphic LCD panel (128 x 64 pixel)</p> <p>Interface 8 GB SSD / 2 GB RAM</p> <p>Dimensions & Weight 10/100/1000BaseT (incl. IPv6), High Speed USB 2.0</p> <p>470 x 470 x 825 mm (W x D x H), ~ 45 kg</p>	<p>OPTIONS</p> <p>CARD READER e-BRIDGE ID-GATE – TWN3/4xx</p> <p>INK CARTRIDGE For Erasing mark counter</p> <p>¹⁾ Optional</p> 
Scan	<p>Resolution Max. 300 x 300 dpi</p> <p>Scan Speed Up to 30 ipm</p> <p>Scan Modes Colour, Greyscale, Monochrome, Blue Original</p> <p>File Formats JPEG, Multi/Single Page TIFF/PDF/Slim PDF</p> <p>Scan Functions Single pass duplex scanning, Scan to USB, Scan to File (SMB, WebDAV)</p>	
Erase & Sort	<p>Erase Speed Up to 30 sheets per minute</p> <p>Erase & Sort Functions Single pass duplex erasing of Blue Original Toner and ink from Pilot FriXion pens and highlighters, Sorting based on paper condition analysis, Erasing mark counter¹⁾</p>	
System & Security	<p>Device Management TopAccess for remote administration and configuration (incl. reuse counter settings)</p> <p>System Features 10 public templates and 10 private templates per user for storage of personalised settings and workflows, Energy save modes</p> <p>Accounting & Security LDAP support, 1,000 department & 10,000 user codes, card reader¹⁾, IP and MAC address filter, port filter, support of SSL protocols</p>	

Productivity and paper specifications are related\ to a paper size of A4 and a paper weight of 80 gsm if not otherwise mentioned.





e-STUDIO306LP



General	<p>Print & Copy Speed 30 ppm (A4) 16 ppm (A3)</p> <p>Warm-up Time Approx. 65 seconds</p> <p>Paper Size & Weight Cassettes: A5R-A3, 64-80 gsm Bypass: A5R-A3, 64-80 gsm</p> <p>Paper Capacity 2 x 550 sheets (Cassettes), 100 sheets (Bypass) Maximum: 2,300 sheets</p> <p>Automatic Duplex A5R-A3, 64-80 gsm</p> <p>Inner Output Tray 550-sheet capacity</p> <p>Controller Type Toshiba e-BRIDGE</p> <p>Control Panel 9" (22.8 cm) colour touch panel LCD</p> <p>Memory Toshiba Secure HDD 160 GB¹⁾ / 1 GB RAM</p> <p>Interface 10/100/1000BaseT (incl. IPv6), High Speed USB 2.0, WLAN²⁾ (IEEE802.11b/g)</p> <p>Dimensions & Weight 575 x 586 x 756 mm (W x D x H), ~ 59 kg</p>
Print	<p>Resolution Max. 2,400 x 600 dpi with smoothing</p> <p>Page Description Languages XPS, PCL6 and PostScript 3 compatible</p> <p>Supported Systems Windows 8/7/Vista/XP/Server 2008/Server 2003 (32/64 bit), Windows Server 2012/Server 2008 R2 (64 bit), Mac OS X 10.5.7 - 10.8, AS/400, Citrix, Linux, Novell Netware (NDPS), SAP, UNIX</p> <p>Print Functions Universal Driver, Driver templates, Driver plug-ins²⁾, Hold print, Print from USB, Tandem printing</p>
Scan	<p>Resolution Max. 600 x 600 dpi</p> <p>Scan Speed 57/43 ipm in monochrome/colour (300 dpi)</p> <p>Scan Modes Auto-Colour (ACS), Colour, Greyscale, Monochrome (incl. Blue Original)</p> <p>File Formats JPEG, Multi/Single Page TIFF/XPS/PDF, Secure PDF, Slim PDF, Searchable PDF²⁾ (and other formats like DOCX, XLSX, RTF, TXT, PDF/A)²⁾</p> <p>Scan Functions WS Scan, Scan to USB, Scan to E-Mail, Scan to File (SMB, FTP, FTPS, IPX/SPX, local), Meta Scan²⁾, Scan to Box (e-Filing), WIA, TWAIN</p>
Copy	<p>Resolution Scan: 600 x 600 dpi</p> <p>First Copy Print: 2,400 x 600 dpi with smoothing</p> <p>Zoom Approx. 4.7 seconds</p> <p>Copy Modes 25-400% (platen), 25-200% (RADF)²⁾</p> <p>Copy Functions Text, Text/Photo, Photo, Colour Document, Blue Original, Custom Electronic sort, 2-in-1/4-in-1 mode</p>
Fax²⁾	<p>Communication Super G3, G3 (opt. 2nd line), Internet Fax T.37</p> <p>Transmission Speed Approx. 3 seconds per page</p> <p>Compression JBIG, MMR, MR, MH</p> <p>Fax Memory 1 GB (HDD) Transmission/Reception</p> <p>Network-Fax Driver Windows 8/7/Vista/XP/Server 2008/ Server 2003 (32/64 bit), Server 2012/Server 2008R2 (64 bit)</p> <p>Incoming Fax Routing To shared folder (SMB, FTP, IPX/SPX), E-mail, e-Filing</p>
System & Security	<p>Device Management e-BRIDGE Fleet Management System²⁾, TopAccess for remote administration and configuration</p> <p>System Features e-Filing document server for secure storage, document distribution and Print on Demand (1 public box, 200 user boxes), 12,060 One-touch Templates for storage of personalised settings or workflows, e-BRIDGE Open Platform²⁾, Embedded Web Browser, Job Skip</p> <p>Accounting & Security Role Based Access, LDAP support, 1,000 department codes & 10,000 user codes, card reader²⁾, private print, standard data encryption with Toshiba Secure HDD, Data Overwrite Enabler²⁾, IP and MAC address filter, port filter, support of SSL and IPSec²⁾ protocols, IEEE802.1x support, IEEE2600.1 compliant²⁾, Scan to Secure PDF</p> <p>Productivity and paper specifications are related to a paper size of A4 and a paper weight of 80 gsm if not otherwise mentioned.</p>

OPTIONS

RADF – MR-3026

100-sheet capacity, A5R-A3, 35-157 gsm

JOB SEPARATOR TRAY – MJ-5009

2 inner trays, 150- and 250-sheet capacity

PAPER FEED PEDESTAL – KD-1033

550-sheet (1 drawer), A5R-A3, 64-80 gsm
668 x 701 x 291.5 mm (W x D x H), ~ 21 kg

e-STUDIO RD30 – KH-1020EU

Paper Reusing Device

OTHER OPTIONS

DESK – MH-2520

DRAWER MODULE – MY-1042

FAX BOARD – GD-1250EU-F

DATA OVERWRITE ENABLER – GP-1070

e-BRIDGE ID-GATE – TWN3/4xx

WIRELESS LAN MODULE – GN-1060

META SCAN ENABLER – GS-1010

IPsec ENABLER – GP-1080

UNICODE FONT ENABLER – GS-1007

e-BRIDGE RE-RITE – GB-1280

ACCESSIBLE ARM – KK-2550

¹⁾ 1GB = 1 billion bytes; the actual formatted capacity is less. Available capacity will also be less if software applications are pre-installed.

²⁾ Optional



Insight Systems Ltd

w: www.insightsystems.co.uk

e: sales@insightsystems.co.uk

t: 01732 880600

TOSHIBA TEC UK IMAGING SYSTEMS LTD

ABBEY CLOISTERS, ABBEY GREEN,
CHERTSEY, SURREY KT16 8RB
TEL 01932 580100 FAX 01932 580101
WWW.TOSHIBATEC.CO.UK

Follow us on [twitter](#) @ToshibaTEC_UK



Jav.63392.0713

TOSHIBA
Leading Innovation >>>

6BY0COP1587

Technical data is subject to change without prior notice. All company and/or product names are trademarks and/or registered trademarks of their respective manufacturers in their markets and/or countries. All rights reserved. We are constantly making efforts to deliver the latest status of data to our partners. Specifications for some models may change in the time between the production and the release of this documentation. Copyright © 2013 TOSHIBA TEC. BR306LPD30G6MD1305